

- **No Waiting At Any Time**
- **No Waiting Mon-Sat 0600-2000**
- **No Waiting Mon-Sat 0630-1830**
- **No Waiting Mon-Fri 0630-1830**
- **No Waiting Mon-Sun 0630-1830**
- **No Waiting Mon-Sat 0630-1830**
- **No Waiting Mon-Fri 0630-0900 & 1430-1530**
- **Parking Mon-Sat 0600-1800 30mins no return 2hrs**

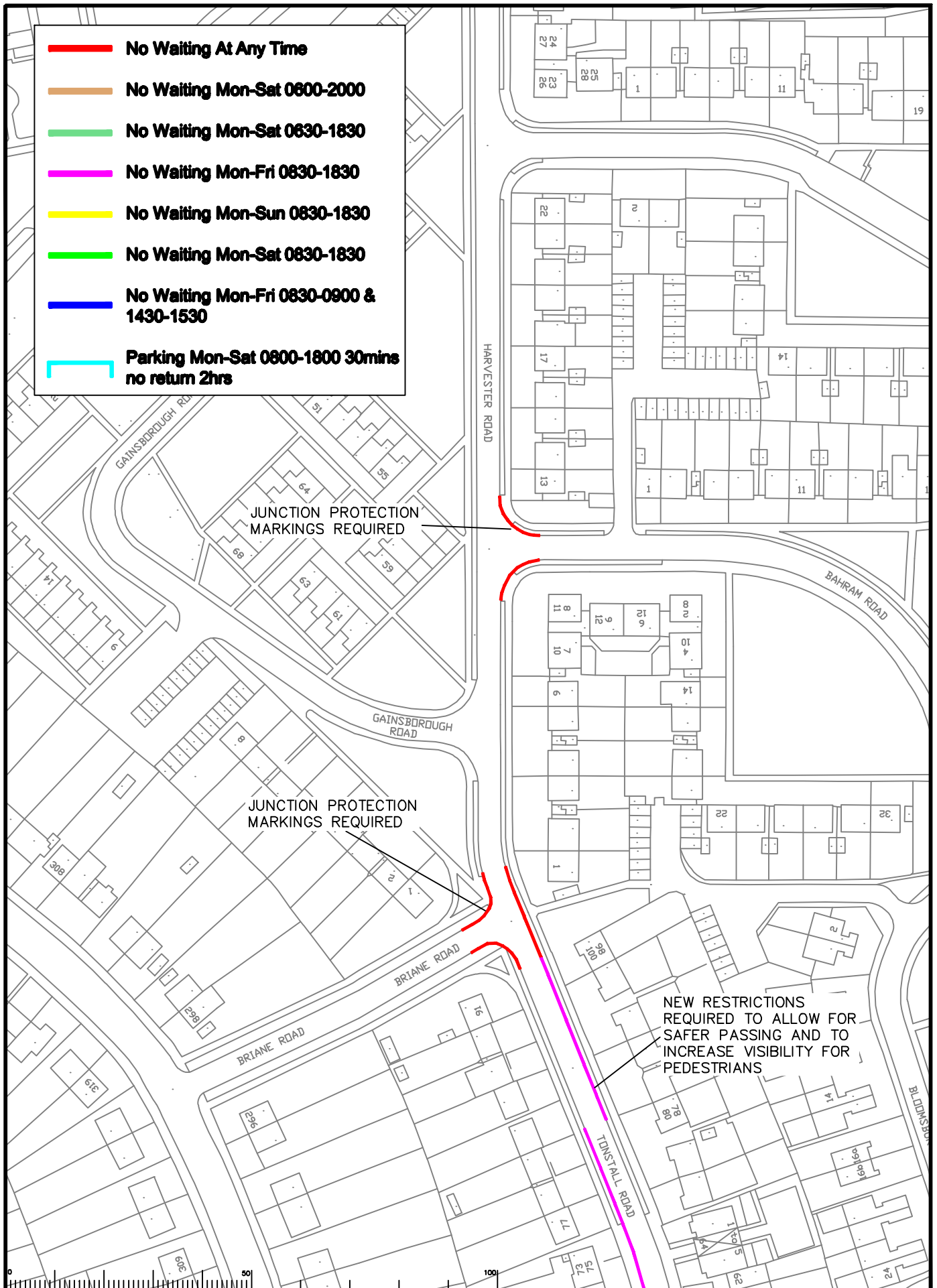

| Rev. | Description | Drawn | Sig. | Date | Chkd | Sig. | Date | Appr | Sig. | Date |
|------|-------------|-------|------|------|------|------|------|------|------|------|
| | | | | | | | | | | |
| | | | | | | | | | | |
| | | | | | | | | | | |
| | | | | | | | | | | |
| | | | | | | | | | | |
| | | | | | | | | | | |
| | | | | | | | | | | |
| | | | | | | | | | | |
| | | | | | | | | | | |
| | | | | | | | | | | |

I warrant that the Ordinance hereby proposed is the intention of the Director of Highways/Elected Members of the Council. © Crown copyright. Unauthorised reproduction without the permission of the Controller of Her Majesty's Stationery Office is prohibited.

Drawn by: SDC
 Checked by: TPC
 Approved by: RB

Date: 28.11.09
 Date: 28.11.09
 Date: 28.11.09

EPSOM AND EWELL
PROPOSED PARKING RESTRICTIONS FOR PHASE 5

LOCATION PLAN
OF PROPOSED RESTRICTIONS

SHEET OF

SURREY COUNTY COUNCIL
 Home Office
 Council House, Guildford, Surrey GU1 2AA

Project No. _____
 Drawing No. **24**
 Revision No. _____
 Scale: _____
 Date: _____
 Author: _____
 Checker: _____
 Approver: _____
 Status: **COMM**